

# elfa® freestanding

Easy to assemble, the only tool required is a rubber mallet.



elfa® freestanding is a fully customised shelving and drawer system that is not attached to the wall. It is self-standing and utilises standard elfa® shelves, drawers and components.

elfa® freestanding is excellent for anyone who wants a shelving system that is customised and can be reconfigured as needs change.

## Step 1

Slide the upright into foot. To secure, tap the upright using a rubber mallet. Make sure the upright is slotted all the way into the foot.

## Step 2

Insert crossbraces into holes diagonally at bottom of uprights.

## Step 3

Lift both feet to lock in crossbraces. Secure the stabilisation bar by tapping the left and right ends of the bar with a rubber mallet until both are locked into place.

## Step 4

Add stabilisation bar to top of unit. Add upright caps for a flushed finish. Add feet to the other side of the uprights for a double sided unit.

### To attach a ventilated shelf to the feet (Diagram A)

Lay the ventilated shelf across the span between the feet. Start at the back of the shelf, snap the shelf clip (sold with feet) into the notches on both sides on the foot. Repeat for all four corners of the shelf.

### To install a back stop bar (Diagram B)

Holding the back stop bar at a slight angle, slide the top tabs of the bar into the upright. Press the back stop bar down to lock in in place.



Step 1

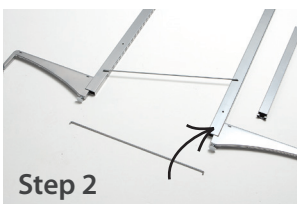

Step 2



Step 3

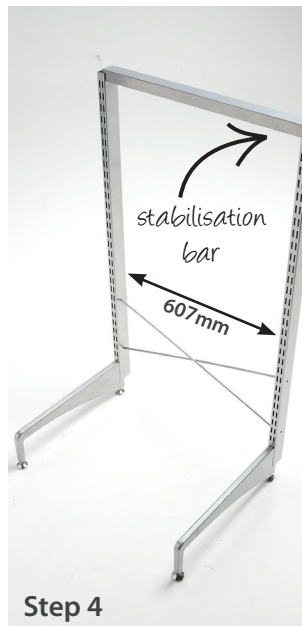

Step 4

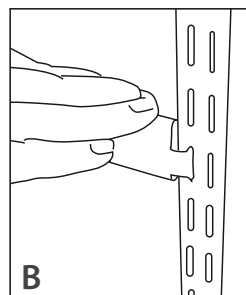
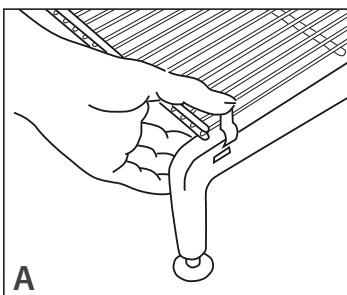

## TIP

- You must protect the floor first if assembling on tile or wood.
-  Visit [hsw.com.au](http://hsw.com.au) for an online video demonstration.

Store locations  
Online shopping  
Franchise opportunities

[hsw.com.au](http://hsw.com.au)  
Freecall 1300 666 616

